



## **VAC-U-BENCH**

**True Quality in  
Metal Finishing Equipment**

# The VAC-U-BENCH for Grinding

## Standard Units

The ICM **VAC-U-BENCH** down draft work table is designed to provide a brightly lighted, quiet, dust free work station. The blower assembly creates a down draft velocity at the tables open areas (the plastisol coated work grates). This down draft velocity carries contaminants away from the operator and into the dust collector.

### Special features of a standard **VAC-U-BENCH**:

- Plastisol coated work grate
- 2 sizes of down draft work areas
- 4 dust collector sizes
- 2 downdraft velocities
- Masonite bench top
- Well lit work area
- Auxiliary electrical outlets



# ing, Sanding and Deburring

## Custom Designs

I.C.M. will engineer a custom **VAC-U-BENCH** for parts that vary in shape and size. Our advanced engineering and your knowledge of your part, teamed together, will create an efficient **VAC-U-BENCH** that keeps the work area clean and safe while increasing productivity.

The ICM custom **VAC-U-BENCH** utilizes:

- Back draft air movement
- Special hoods
- Strip curtains
- Multiple work stations
- Removable partitions

Items to consider when customizing a **VAC-U-BENCH**:

- Size and weight of part
- Mobility of part
- Type of tooling being used
- Work station height
- Capture velocity

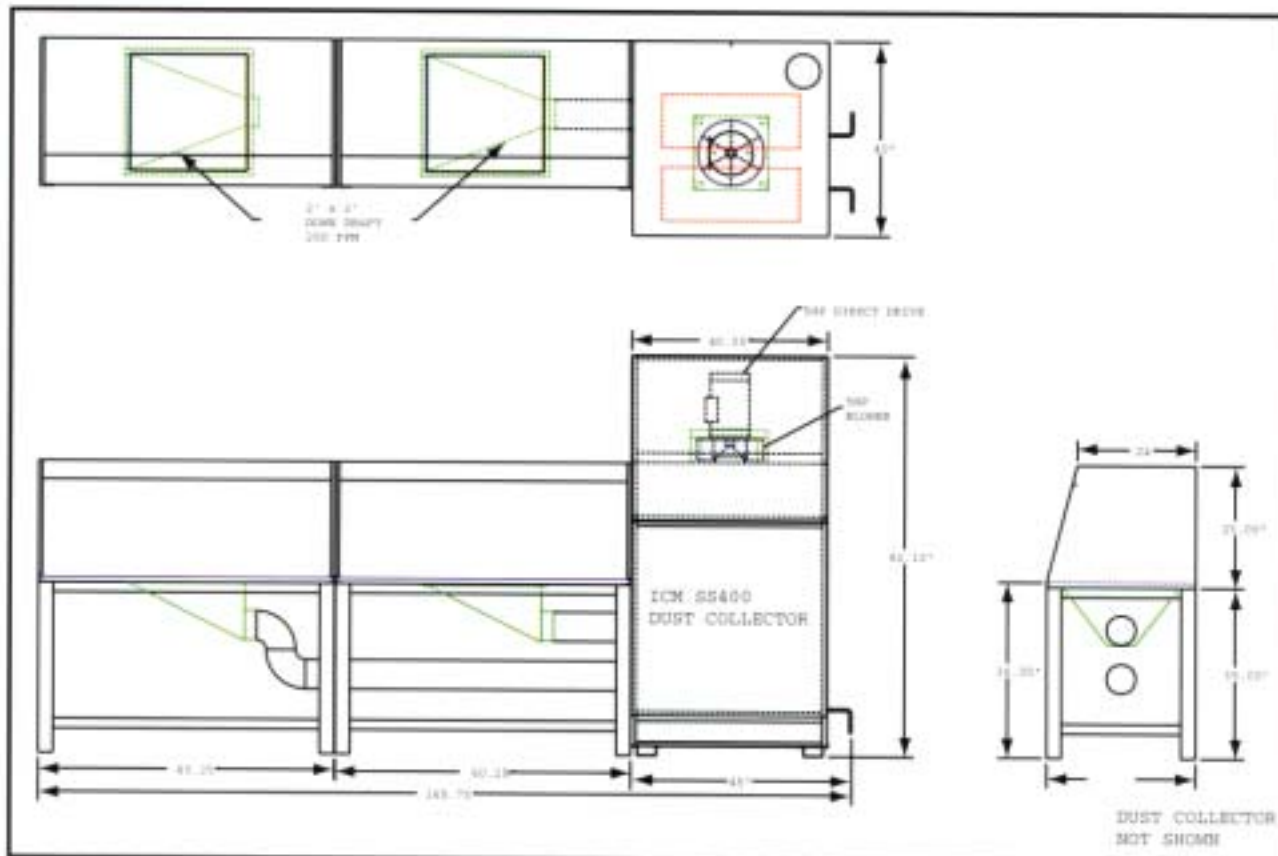

# VAC-U-BENCH

## Dimensions and Specifications

STANDARD MODELS	DOWNDRAFT WORK AREA	DOWNDRAFT WORK VELOCITY	BLOWER SIZE	DUST COLLECTOR
VUB-200-12:	12" x 12"	200 feet/min	1/3 hp, 115v, 1Ø, 60hz	SS60E: 60 sq ft of filter area
VUB-500-12:	12" x 12"	500 feet/min	1 hp, 115v, 1Ø, 60hz	SS100E: 100 sq ft of filter area
VUB-200-24:	24" x 24"	200 feet/min	2 hp, 240/480v, 3Ø, 60hz	SS200E: 200 sq ft of filter area
VUB-500-24:	24" x 24"	500 feet/min	5 hp, 240/480v, 3Ø, 60hz	SS400E: 400 sq ft of filter area

Note: all velocities are measured at grate level.

OVERALL DIMENSIONS				SHIPPING WEIGHTS
VUB-200-12:	Width 79"	Height 84"	Depth 30"	800 LBS
VUB-500-12:	Width 79"	Height 84"	Depth 30"	900 LBS
VUB-200-24:	Width 90"	Height 84"	Depth 30"	1000 LBS
VUB-500-24:	Width 93"	Height 84"	Depth 41"	1300 LBS

Note: dimensions from top of work table to bottom of hood is 27" on all standard benches.

### ALL STANDARD MODELS

Table size:	48" wide x 30" deep
Overall size:	69" wide x 75" high x 30" deep
Work grate:	#9 expanded metal, plastisol coated, easily removed
Lights:	(2) each fluorescent 48" tubes, 40 watts
Controls:	115 volts and (2) 115 volt auxiliary electrical outlets
Sound Level:	From 72 db on the 'A' scale to 75 db on the 'A' scale



ICM, Inc.  
 10630 S. Garfield Avenue  
 South Gate, CA 90280  
 Toll Free (888) 351-2570  
 (562) 869-3004 Voice  
 (562) 869-3005 Fax  
 Web Site: [www.icm2000.com](http://www.icm2000.com)  
 E-Mail: [info@icm2000.com](mailto:info@icm2000.com)

