

SUPER AD-A-BLAST

Installation * Operation * Maintenance * Replacement Parts

**I.C.M., Inc.
10630 South Garfield Avenue
South Gate, CA 90280-7395**

**Telephone: (562) 869-3004
Toll Free: (888) 351-2570**

**Fax: (562) 869-3005
Web Site: www.icm2000.com
Email: info@icm2000.com**

TABLE OF CONTENTS

Page 1	Installation
Page 2	Operation
Page 3	Maintenance
Page 4	What May Cause Machine not to Operate
Page 5	Cabinet Replacement Parts
Page 6	Aluminum Gun Body
Page 7	Aluminum Gun Body Replacement Parts
Page 8	Dust Collector Replacement Parts ("ED" Models)
Page 9	Dust Bag Assembly
Page 10	Dust Bag Replacement Parts
Page 11	Super Ad-A-Blast Replacement Parts List
Page 12	Super Ad-A-Blast Replacement Parts List ("ED" Models)

INSTALLATION

- 1.0 **After location of machine, be sure to check size of plant air coming to unit.**

- 1.1 **Electrical connection is AC 120 volts.**

- 1.2 **CAUTION:**

**MAKE SURE SOURCE IS FREE AND DRY OF OIL BEFORE IT REACHES
THE BLASTING MACHINE.**

OPERATION

- 2.0 Turn light and blower switch "ON".
- 2.1 Pour 50 lbs. of desired abrasive into machine hopper.
- 2.2 **CAUTION:**
IF MACHINE IS EQUIPPED WITH A PARTICLE SEPARATOR, BE SURE THAT THE ABRASIVE COVERS THE SEPARATOR RETURN HOSE AT ALL TIMES. IF ABRASIVE DOES NOT COVER HOSE END, THE ABRASIVE WILL CARRY OVER INTO THE DUST COLLECTOR.
- 2.3 If the machine is equipped with an air regulator kit, select desired blasting pressure by adjusting air regulator.
- 2.4 To turn air "ON", push arm button once. The arm button is located on the left arm hole.
- 2.5 To turn air "OFF", push arm button once again.
- 2.6 Adjust feeder fitting for proper abrasive flow by rotating insert 0 - 90 degrees. Feeder fitting is located at the bottom of machine hopper.
- 2.7 **CAUTION:**
TOO MUCH ABRASIVE FLOW WILL CAUSE SURGING OF THE GUN. TOO LITTLE ABRASIVE FLOW WILL STOP CLEANING ACTION.
- 2.8 To change abrasive, unscrew cap at bottom of feeder fitting and drain abrasive into container.

MAINTENANCE

- 3.0** **Avoid dropping small parts into abrasive hopper. These parts can become clogged in the feeder fitting and cause the flow of abrasive to stop. Should this happen, remove feeder fitting and gun. Clean fitting, hoses, and gun.**

- 3.1** **Check blasting gun for wear, especially the air jet (located inside the gun). Rotation of the air let nozzle is necessary when wear appears. This is accomplished by loosening the tightening screws in the aluminum gun body.**

- 3.2** **Check abrasive hose for wear and replace when necessary.**

- 3.3** **Remove foam filters from top of machine and blow clean when they become dirty or clogged.**

- 3.4** **Rap dust bag(s) after every four (4) hours of machine use.**

WHAT MAY CAUSE MACHINE NOT TO OPERATE

4.0 WET ABRASIVE:

Wet abrasive will not flow.

4.1 WET AIR:

Wet air will cause your abrasive to become damp and stop flow.

4.2 FEEDER FITTING NOT ADJUSTED:

This will not give you correct abrasive flow for blasting.

4.3 DUST BAG(S) AND/OR FOAM FILTERS NEED CLEANING:

This will cause poor visibility.

4.4 IMPORTANT:

- DO NOT AIM BLASTING GUN AT VIEW WINDOW.**
- PUT ONLY DRY AND FREE OF OIL PARTS IN CABINET FOR CLEANING.**
- DO NOT CHARGE MACHINE WITH WET OR DAMP ABRASIVE.**
- DO NOT SHAKE DUST BAG(S) WITH BLOWER "ON."**
- KEEP PARTICLE SEPARATOR DISCHARGE HOSE COVERED WITH ABRASIVE AT ALL TIMES.**

I.C.M., Inc.

REPLACEMENT PARTS LIST	DATE: 7/86
SUPER AD-A-BLAST / SUPER AD-A-BLAST ED	REVISION:
UNIT: CABINET	
MODEL: 19 & 25	

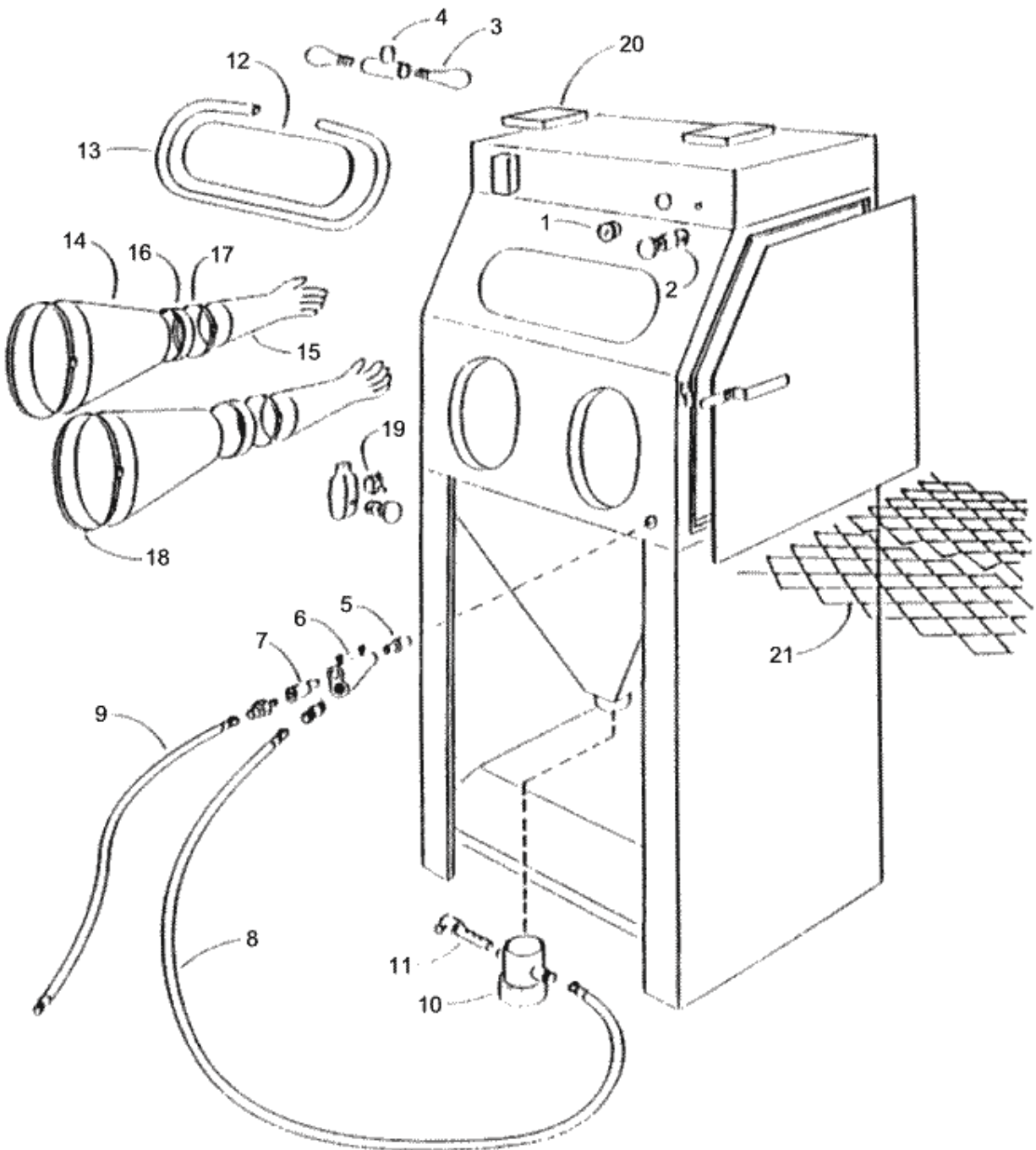

See Page 6 for Item #6 (Aluminum Gun Body)

COMPLETE ASSEMBLY FOR HAND GUN SETUP

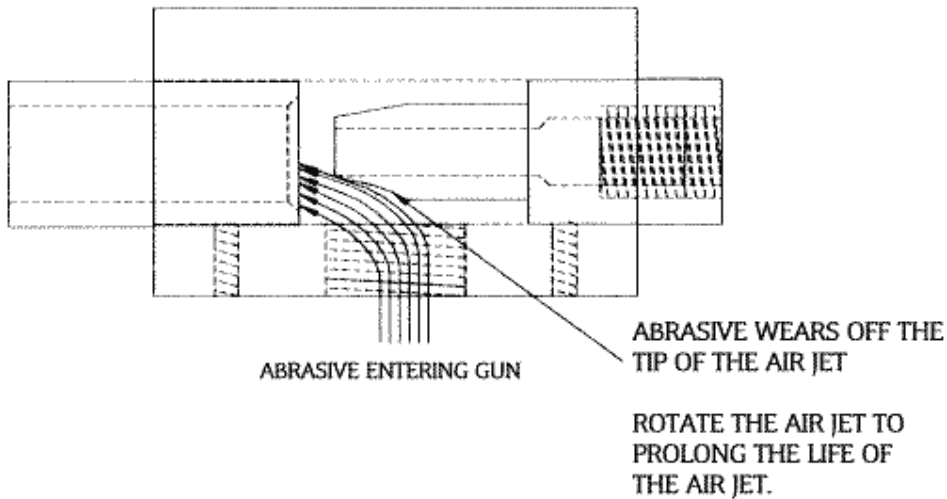
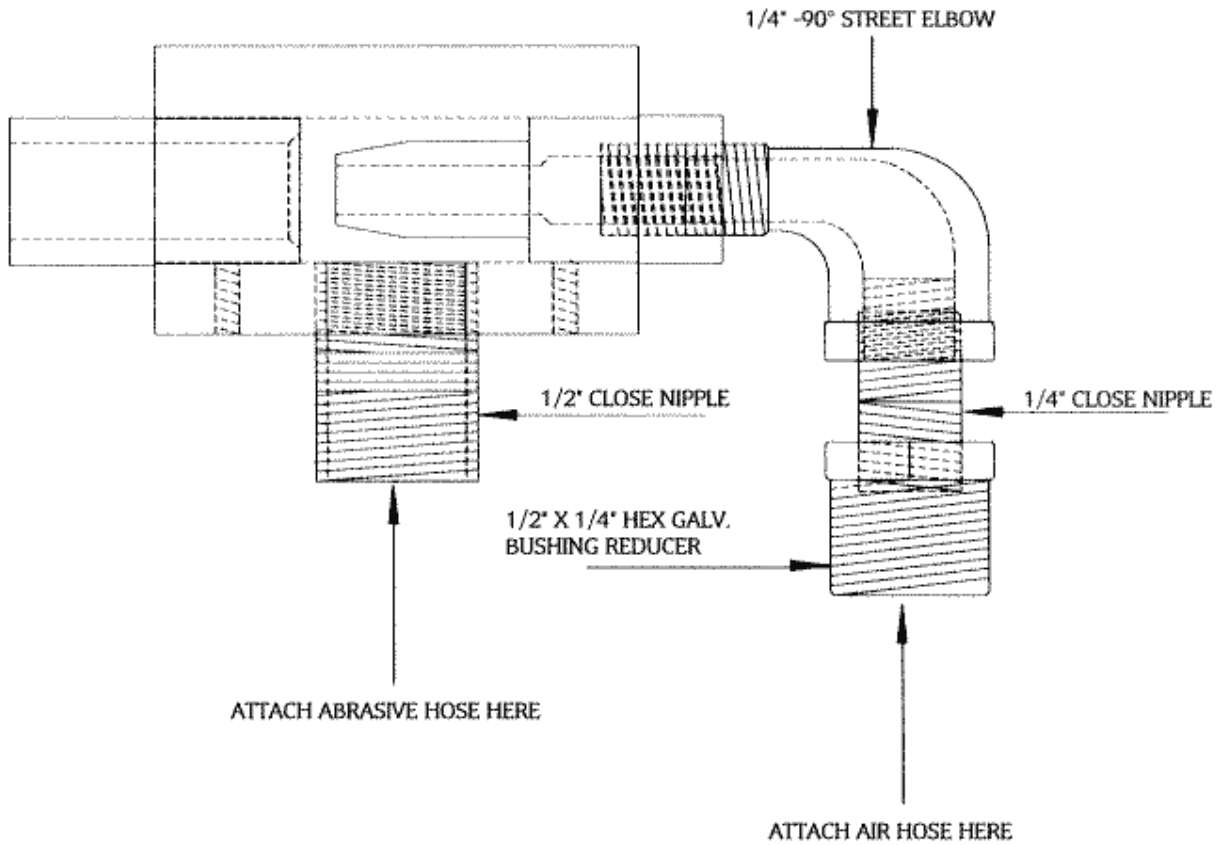

ALUMINUM GUN ASSEMBLY

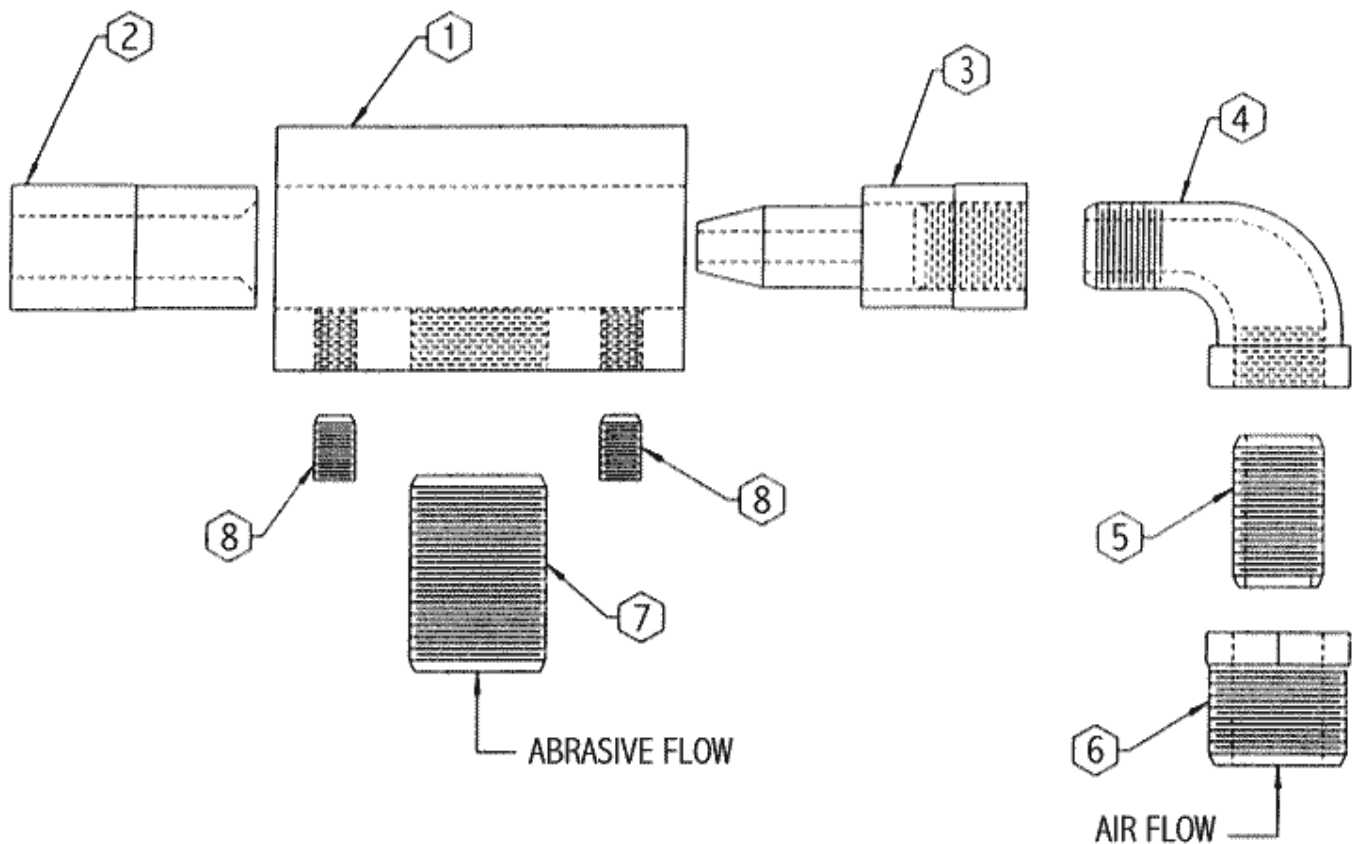

ITEM OR FIND NUMBER	QTY. REQ.	PART OR IDENTIFYING NO.	NOMENCLATURE OR DESCRIPTION
1	1	5002C-1	ALUMINUM GUN BODY
2	1	5002A	1/4" DIA. STEEL NOZZLE
2	1	5002B	3/8" DIA. STEEL NOZZLE
2	1	5002C	1/2" DIA. STEEL NOZZLE
2	1	5003A	1/4" DIA. CARBIDE NOZZLE
2	1	5003B	3/8" DIA. CARBIDE NOZZLE
2	1	5003C	1/2" DIA. CARBIDE NOZZLE
3	1	5004A	1/8" DIA. AIR JET
3	1	5004B	3/16" DIA. AIR JET
3	1	5004C	1/4" DIA. AIR JET
4	1		1/4" 90° STREET ELBOW
5	1		1/4" CLOSE NIPPLE
6	1		1/4" x 1/2" HEX BUSHING REDUCER
7	1		1/2" CLOSE NIPPLE
8	2		5/16-18 x 3/8" SET SCREW

I.C.M., Inc.

REPLACEMENT PARTS LIST	DATE: 7/86
SUPER AD-A-BLAST ED	REVISION:
UNIT: DUST COLLECTOR	
MODEL: 19 & 25	

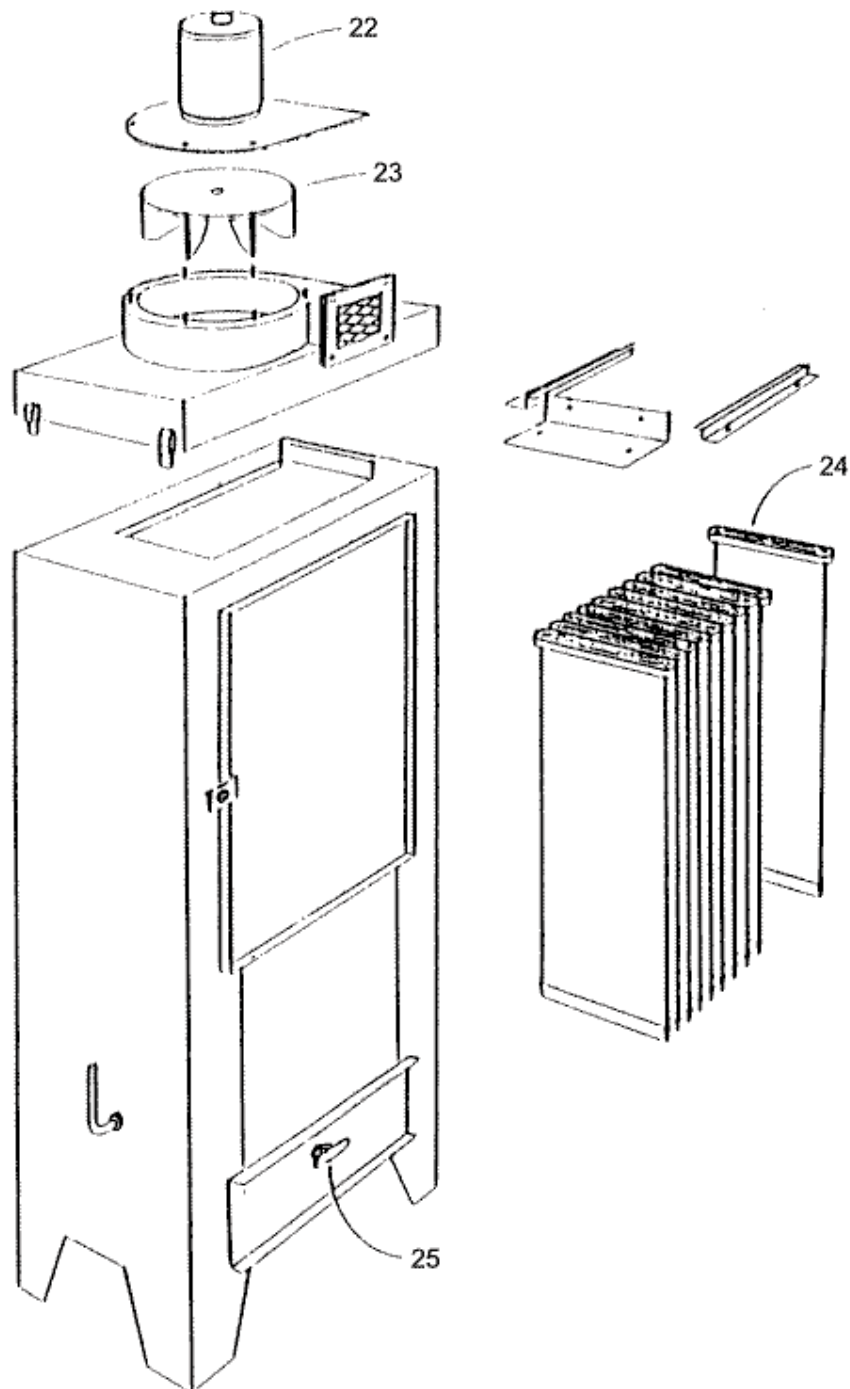

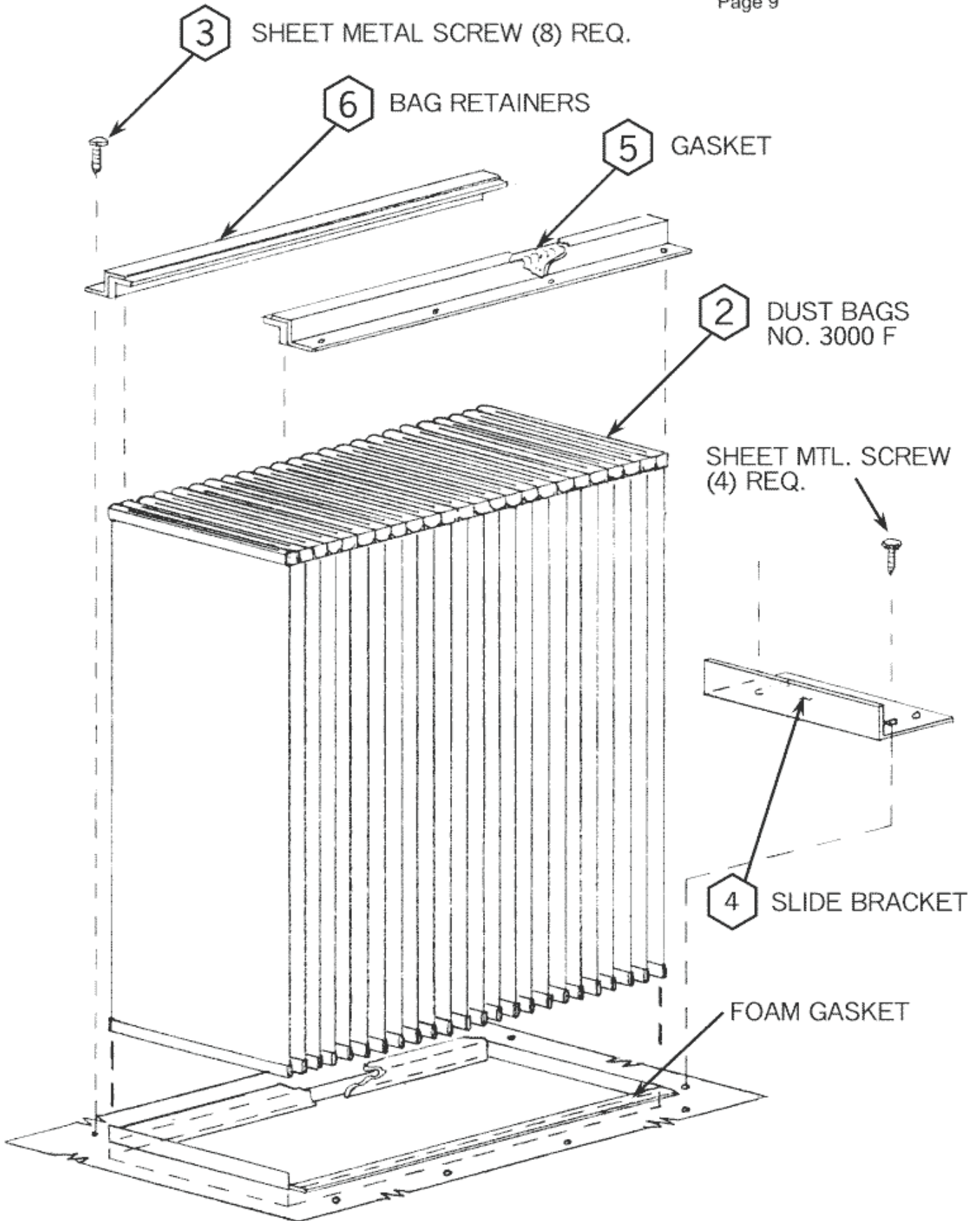

DUST BAG ASSEMBLY

I.C.M., Inc.

REPLACEMENT PARTS LIST	DATE: 7/86
SUPER AD-A-BLAST	REVISION:
UNIT: DUST COLLECTOR	
MODEL: 19 & 25	

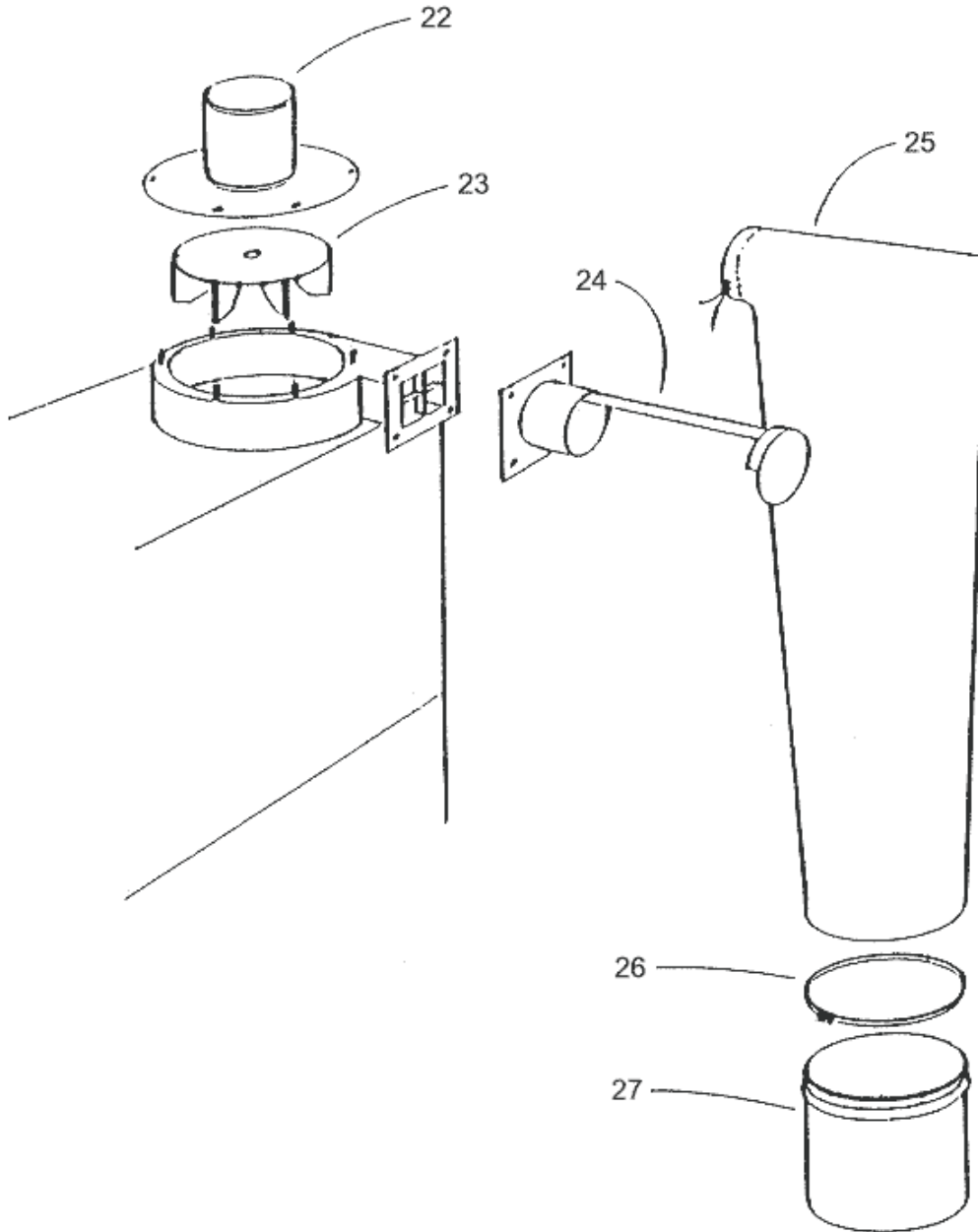

REPLACEMENT PARTS LIST

UNIT:	SUPER AD-A-BLAST
MODEL:	#7, #11, #14, #19, #25

ITEM	PART NO.	DESCRIPTION
1	1000A	2" AIR GAUGE
2	1001B	1/2" AIR REGULATOR
3	2088A	LIGHT BULB
4	4006	LIGHT FIXTURE
5	5000B	3/8" ABRASIVE STEEL NOZZLE
6	5002C-1	ALUMINUM GUN BODY
7	5004B	3/16" AIR JET
8	5005B-60	3/8" X 60" ABRASIVE HOSE, 1 FITTING (MODEL 7)
	5005B-72	3/8" X 72" ABRASIVE HOSE, 1 FITTING (MDL 11 & 14)
	5005A-85	1/2" X 85" ABRASIVE HOSE, 1 FITTING (MDL 19 & 25)
9	5007A-27	1/4" X 27" AIR HOSE, 2 FITTINGS (MODEL 7)
	5007A-32	1/4" X 32" AIR HOSE, 2 FITTINGS (MODEL 11 & 14)
	5008A-40	1/2" X 40" AIR HOSE, 2 FITTINGS (MODEL 19 & 25)
10	5011A	FEEDER FITTING
11	5011B	FEEDER FITTING INSERT
12	6000B	19-13/16" X 5-3/4" WINDOW GLASS (MODEL 7, 11 & 14)
	6000C	23-3/4" X 8-3/16" WINDOW GLASS (MODEL 19 & 25)
13	6002A-52	52" WINDOW MOLDING (MODEL 7, 11 & 14)
	6002A-62	62" WINDOW MOLDING (MODEL 19 & 25)
14	6003A	GAUNTLETS
15	6005C	NEOPRENE CLOTH-LINED GLOVES
16	6006A	GLOVE RINGS
17	6009A	GLOVE CLAMP
18	6009C	GAUNTLET CLAMP
19	7034	1/4" SLIDING SLEEVE VALVE
20	6011A	1" X 5-1/2" X 8" FOAM FILTER
21	6008Q-1	WORK GRATE (MODEL 7)
	6008Q-2	WORK GRATE (MODEL 11)
	6008Q-3	WORK GRATE (MODEL 14)
22	2000J	1/3 HP 3450 RPM MOTOR
23	3005A	9-1/4" IMPELLER
24	-----	DUST BAG SUPPORT
25	3000M	AD-A-BLAST BAG WITHOUT BOTTOM
26	-----	BAG CLAMP
27	-----	DUST PAIL
 OPTIONS		
	1001B-1	REPAIR KIT FOR AIR REGULATOR
	1004A	1/2" FILTER & WATER TRAP
	5003B	3/8" ABRASIVE CARBIDE NOZZLE
	5012A-2	3/8" ABRASIVE CARBIDE, GUN COMPLETE

REPLACEMENT PARTS LIST

UNIT:	SUPER AD-A-BLAST ED
MODEL:	#7, #11, #14, #19, #25

ITEM	PART NO.	DESCRIPTION
1	1000A	2" AIR GAUGE
2	1001B	1/2" AIR REGULATOR
3	2088A	LIGHT BULB
4	4006	LIGHT FIXTURE
5	5000B	3/8" ABRASIVE STEEL NOZZLE
6	5002C-1	ALUMINUM GUN BODY
7	5004B	3/16" AIR JET
8	5005B-60	3/8" X 60" ABRASIVE HOSE, 1 FITTING (MODEL 7)
	5005B-72	3/8" X 72" ABRASIVE HOSE, 1 FITTING (MODEL 11 & 14)
	5005A-85	1/2" X 85" ABRASIVE HOSE, 1 FITTING (MODEL 19 & 25)
9	5007A-27	1/4" X 27" AIR HOSE, 2 FITTINGS (MODEL 7)
	5007A-32	1/4" X 32" AIR HOSE, 2 FITTINGS (MODEL 11 & 14)
	5008A-40	1/2" X 40" AIR HOSE, 2 FITTINGS (MODEL 19 & 25)
10	5011A	FEEDER FITTING
11	5011B	FEEDER FITTING INSERT
12	6000B	19-13/16" X 5-3/4" WINDOW GLASS (MODEL 7, 11 & 14)
	6000C	23-3/4" X 8-3/16" WINDOW GLASS (MODEL 19 & 25)
13	6002A-52	52" WINDOW MOLDING (MODEL 7, 11 & 14)
	6002A-62	62" WINDOW MOLDING (MODEL 19 & 25)
14	6003A	GAUNTLETS
15	6005C	NEOPRENE CLOTH-LINED GLOVES
16	6006A	GLOVE RINGS
17	6009A	GLOVE CLAMP
18	6009C	GAUNTLET CLAMP
19	2007E	1X692 BUTTON SWITCH
	2007E-1	ALUMINUM BUSHING
	2007E-2	RED BUTTON ONLY
	2007E-3	RED BUTTON ARM SWITCH, COMPLETE
20	6011A	1" X 5-1/2" X 8" FOAM FILTER
21	6008Q-1	WORK GRATE (MODEL 7)
	6008Q-2	WORK GRATE (MODEL 11)
	6008Q-3	WORK GRATE (MODEL 14)
22	2000J	1/3 HP 3450 RPM MOTOR
23	3005A	9-1/4" IMPELLER
24	3000F	11" X 39" DUST BAG (17 EACH REQUIRED)
25	-----	DUST DRAWER HANDLE
 OPTIONS		
	1001B-1	REPAIR KIT FOR AIR REGULATOR
	1004A	1/2" FILTER & WATER TRAP
	5003B	3/8" ABRASIVE CARBIDE NOZZLE
	5012B-2	3/8" ABRASIVE STEEL GUN, COMPLETE
	5012A-2	3/8" ABRASIVE CARBIDE GUN, COMPLETE